

TYPE A1
4 IN TOTAL
UNITS 9,13,29,34
FLOOR PLAN SCALE 1:100

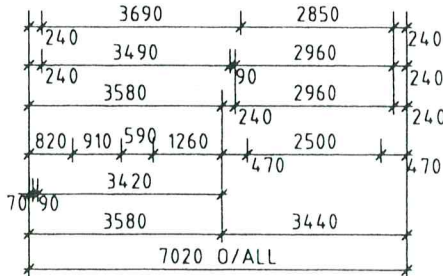
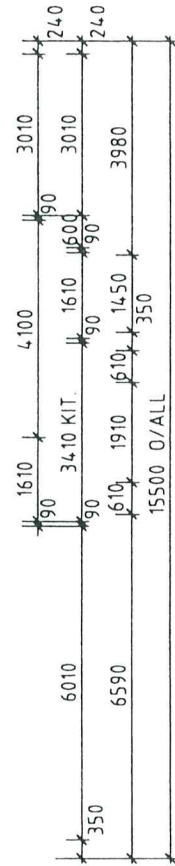
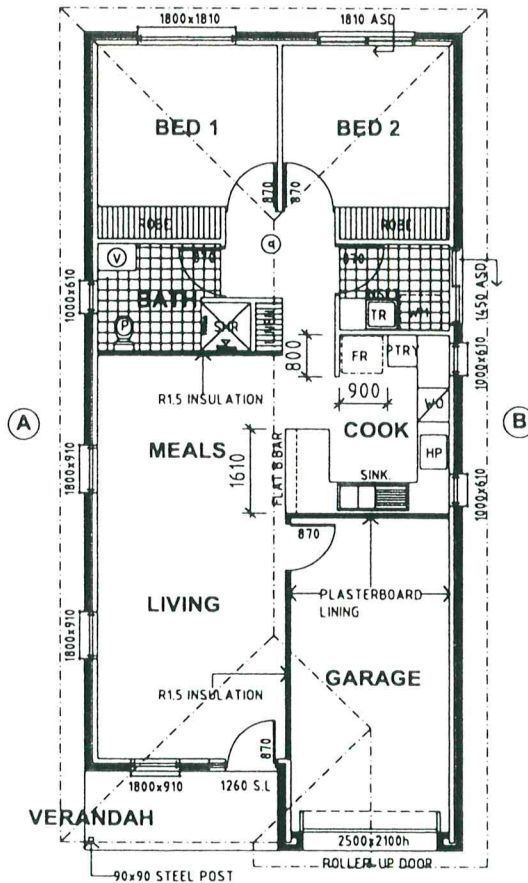
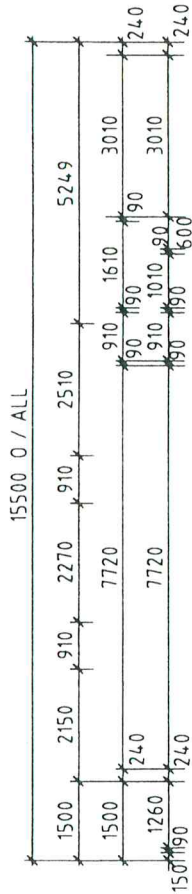
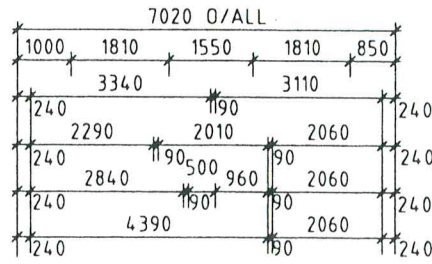

FLOOR PLAN
 SCALE 1:100

JOB NO. 66.2005WD (TYPE A)

Lifestyle

Life's only just begun...

A.C.N 069 942 249
 BUILDERS LICENCE No. GL124 117.GL148938
 16 GEORGE STREET, MOONTA S.A. 5558
 PHONE: (08) 8825 1868 FAX (08) 88251533
 PROPOSED RESIDENTIAL DEVELOPMENT
 FOR: PORT PIRE LIFESTYLE VILLAGE
 LOT 46 AFTON STREET
 PORT PIRE, SA 5540

ENERGY RATING NOTES:

- R1.5 INSULATION TO EXTERNAL LIVING AREA WALLS.
- R3.5 INSULATION TO CEILING (GLASSWOOL)
- R1.5 INSULATION TO INTERNAL WALLS WHERE SHOWN
- EXTERNAL SWING DOORS TO BE FITTED WITH DRAUGHT PROTECTION DEVICES TO BOTTOM EDGE OF EACH LEAF.
- HOT WATER SUPPLY SYSTEM DESIGNED AND INSTALLED IN ACCORDANCE WITH SECTION 6A OF AS/NZS 3500.4.2 OR CLAUSE 3.38 OF AS/NZS 3500.5

CONSTRUCTION NOTE:

- ⊙ DENOTES HARD WIRED SMOKE ALARMS WITH 9 VOLT BATTERY BACK UP TO COMPLY WITH CLAUSE 9.7 OF S.A. HOUSING CODE.
- ⊙ FULL HEIGHT CONTROL JOINTS IN ACCORDANCE WITH ENGINEERS DOCUMENTATION.
- (SB0) DENOTES STEEL BEAM OVER TO ENGINEERS DESIGN AND DETAILS.

Figured dimensions shall take precedence over scaled drawings. Verify dimensions and levels before commencement. Any discrepancy shall be reported to the Designers immediately.	AREAS: (PER DWELLINGS)
© Copyright	M. LIVING : 81.05
	GARAGE : 20.71
	VERANDAH : 5.19
	TOTAL : 106.95
	sq.m. (1151 SQUARES)
DEPTH : 15.500m	
WIDTH : 6.900m	