

TYPE C

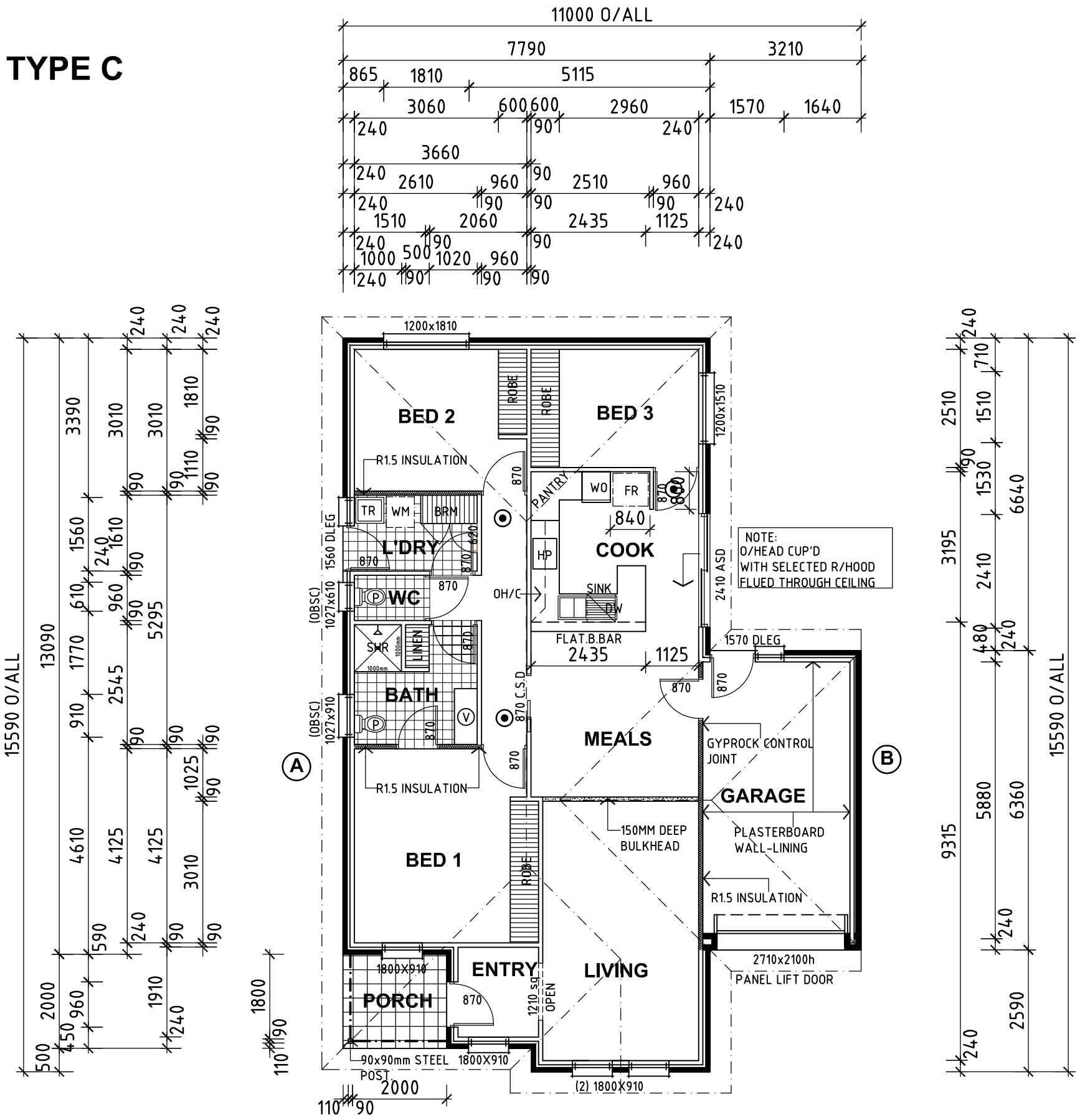

FLOOR PLAN SCALE 1:100
3 IN TOTAL
UNITS 9,28,31,

JOB NO. 66.2005WD (TYPE C)

ENERGY RATING NOTES:

- R1.5 INSULATION TO EXTERNAL LIVING AREA WALLS.
- R3.5 INSULATION TO CEILING. (GLASSWOOL).
- R1.5 INSULATION TO INTERNAL WALLS WHERE SHOWN.
- EXTERNAL SWING DOORS TO BE FITTED WITH DRAUGHT PROTECTION DEVICES TO BOTTOM EDGE OF EACH LEAF.
- HOT WATER SUPPLY SYSTEM DESIGNED AND INSTALLED IN ACCORDANCE WITH SECTION 6A OF AS/NZS 3500.4.2 OR CLAUSE 3.38 OF AS/NZS 3500.5

CONSTRUCTION NOTE:

- ☉ DENOTES HARD WIRED SMOKE ALARMS WITH 9 VOLT BATTERY BACK UP TO COMPLY WITH CLAUSE 9.7 OF S.A. HOUSING CODE.
- ⊕ FULL HEIGHT CONTROL JOINTS IN ACCORDANCE WITH ENGINEERS DOCUMENTATION.

A.C.N 069 942 249
 BUILDERS LICENCE No. GL124 117, GL148938
 16 GEORGE STREET, MOONTA S.A. 5558
 PHONE: (08) 8825 1868 FAX (08) 88251533
 PROPOSED RESIDENTIAL DEVELOPMENT
 FOR: PORT PIRIE LIFESTYLE VILLAGE
 LOT 46 AFTON STREET
 PORT PIRIE, SA 5540

AREAS: (PER DWELLINGS)	
M. LIVING	: 114.12
GARAGE	: 21.33
PORCH	: 4.40
TOTAL	139.85sq.m. (15.08 SQUARES)
DEPTH	: 15.590m
WIDTH	: 11.000m

Figured dimensions shall take precedence over scaled drawings. Verify dimensions and levels before commencement. Any discrepancy shall be reported to the Designers immediately.
 ©Copyright